

S.Connection 1

Plane lattice girder

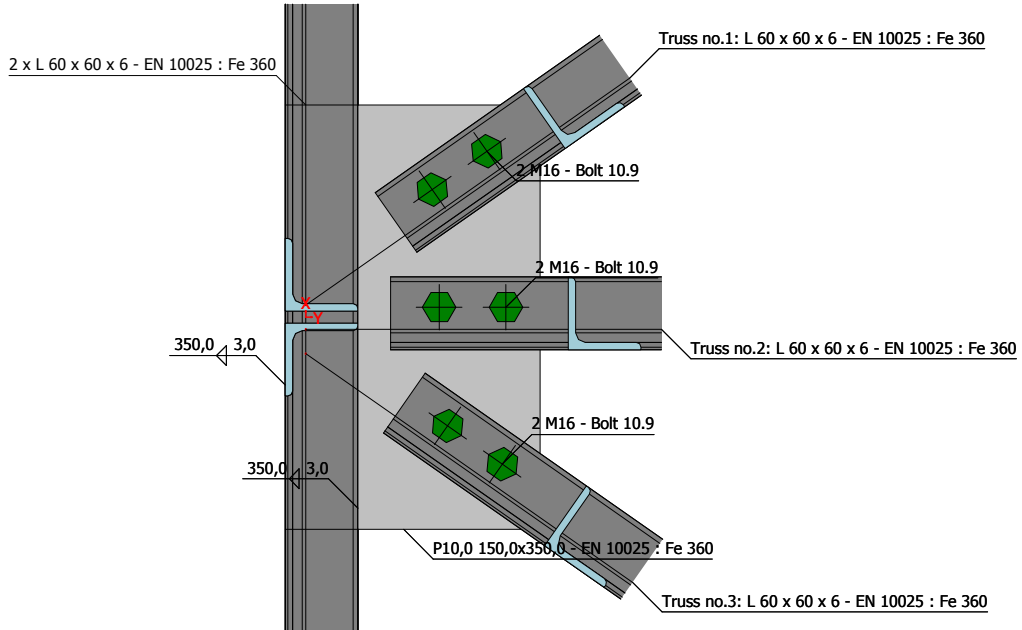

Overall check : **PASS** (57,43%)

Decisive load : L 1 - Load 1

Joint plate capacity : Max utilization (14,20%)

Member no.1 capacity : $N_{1,Rd} = 78,4 \text{ kN}$ (57,43%)

Member no.2 capacity : $N_{2,Rd} = 93,0 \text{ kN}$ (55,90%)

Member no.3 capacity : $N_{3,Rd} = 93,0 \text{ kN}$ (47,30%)

Check : PASS